



# Backwash Filter Valve

## Maintenance Instructions

**350-4X4**

Water Control Solutions



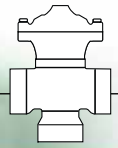

## I. Disassembling the actuator from the valve



A. Disconnect the control tube.

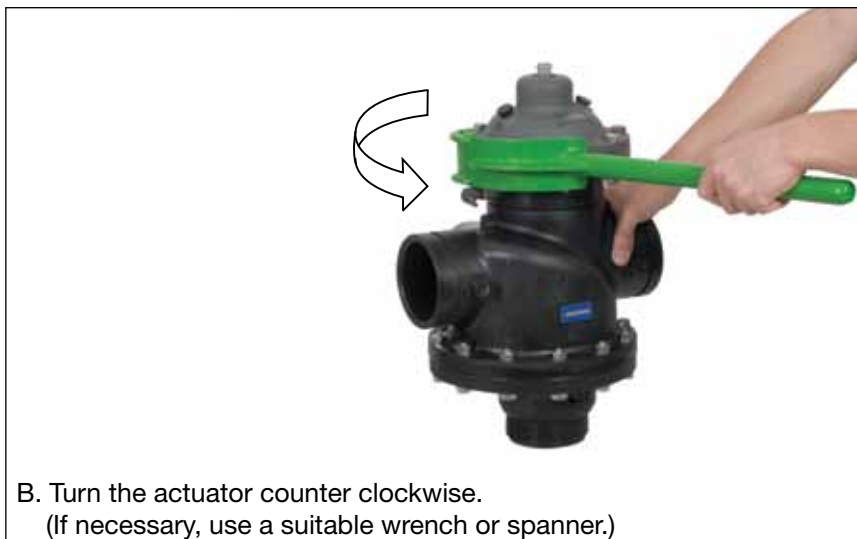

B. Turn the actuator counter clockwise.  
(If necessary, use a suitable wrench or spanner.)



C. Pull or Slide the actuator out of the valve body, pulling gently upwards.

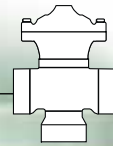

## 2. Replacing the seal



A. Release the closure locking nut, using two 13/19mm wrenches.



B. Remove the plug washer and then remove the seal. Check the condition of the seal and replace as required.

Angle Flow Model		Straight Flow Model	
<b>13</b> Nut	→ [Nut]	<b>13</b> Nut	→ [Nut]
Disc	→ [Disc]	Disc	→ [Disc]
Black Plug	→ [Black Plug]	Gray Plug	→ [Gray Plug]
<b>18</b> Dynamic Seal	→ [Dynamic Seal]	<b>18</b> Dynamic Seal	→ [Dynamic Seal]
<b>25</b> O-Ring	→ [O-Ring]	<b>25</b> O-Ring	→ [O-Ring]
Gray Plug	→ [Gray Plug]	Black Plug	→ [Black Plug]
Disc	→ [Disc]	Disc	→ [Disc]

C. Replace the components of the closure assembly in the order shown here, from bottom to top. Pay attention to the position of the parts and their direction according to the different models (Angular model - black cover; Straight model - gray cover).

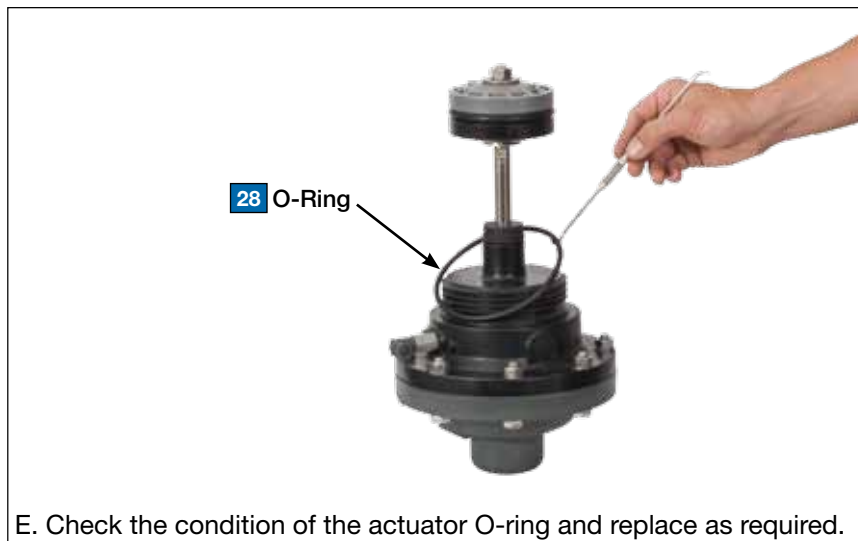
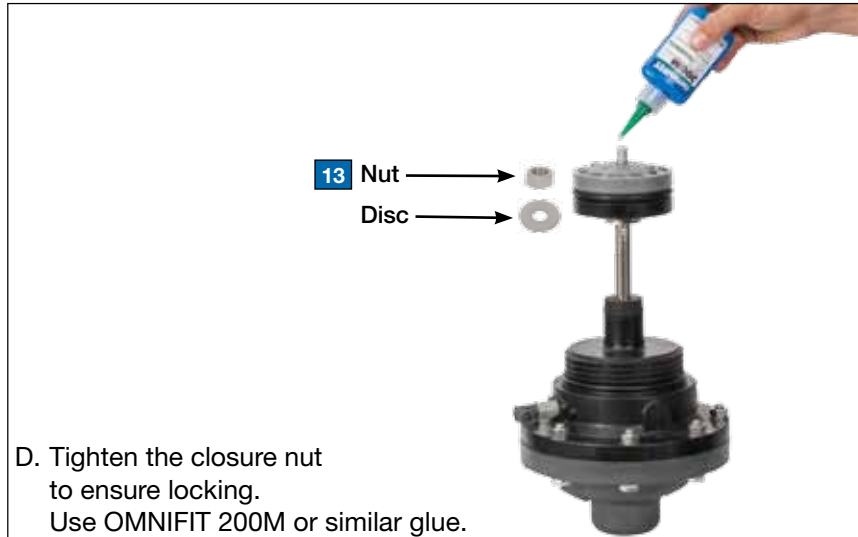
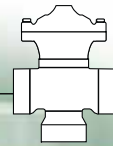

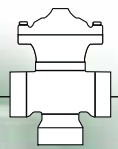

### 3. Replacing the diaphragm

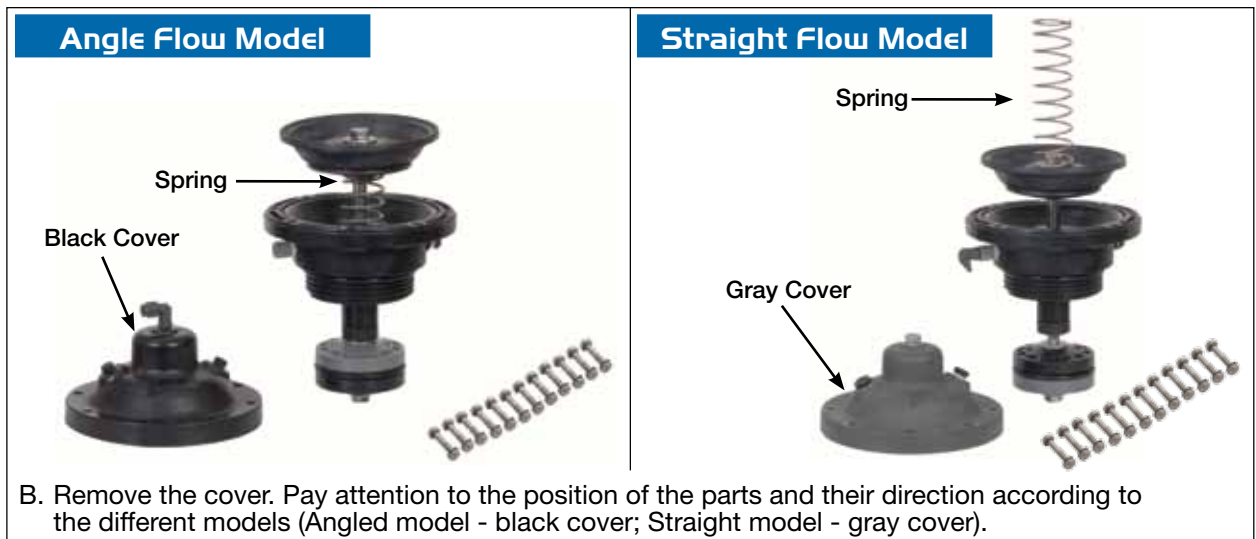

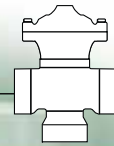

D. Open the locking nut with the aid of two wrenches - a 19mm spanner and 13mm spanner.

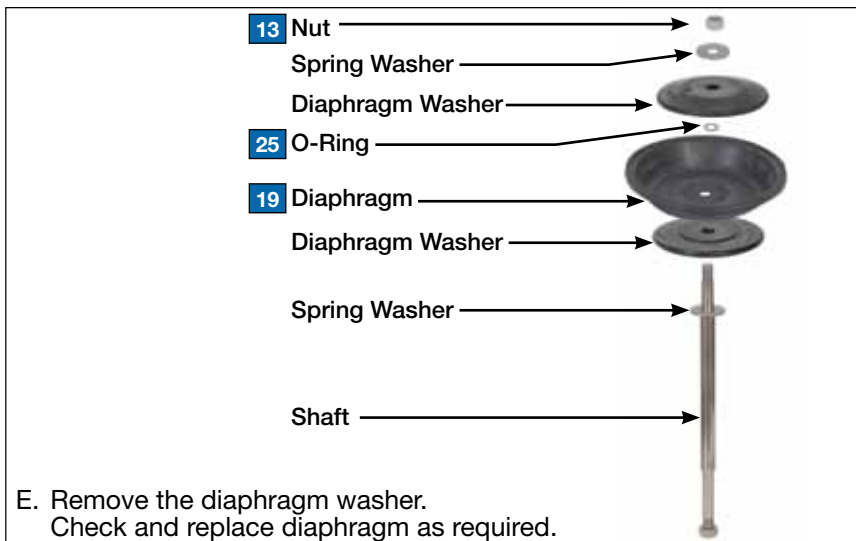

E. Remove the diaphragm washer.  
Check and replace diaphragm as required.



F. Reassemble the diaphragm assembly, paying attention to the order of the parts and their position in accordance with the type of model.  
To ensure locking of the nut, use OMNI200M glue ,or equivalent.



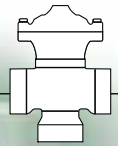

### 4. Replacing the Shaft Seals

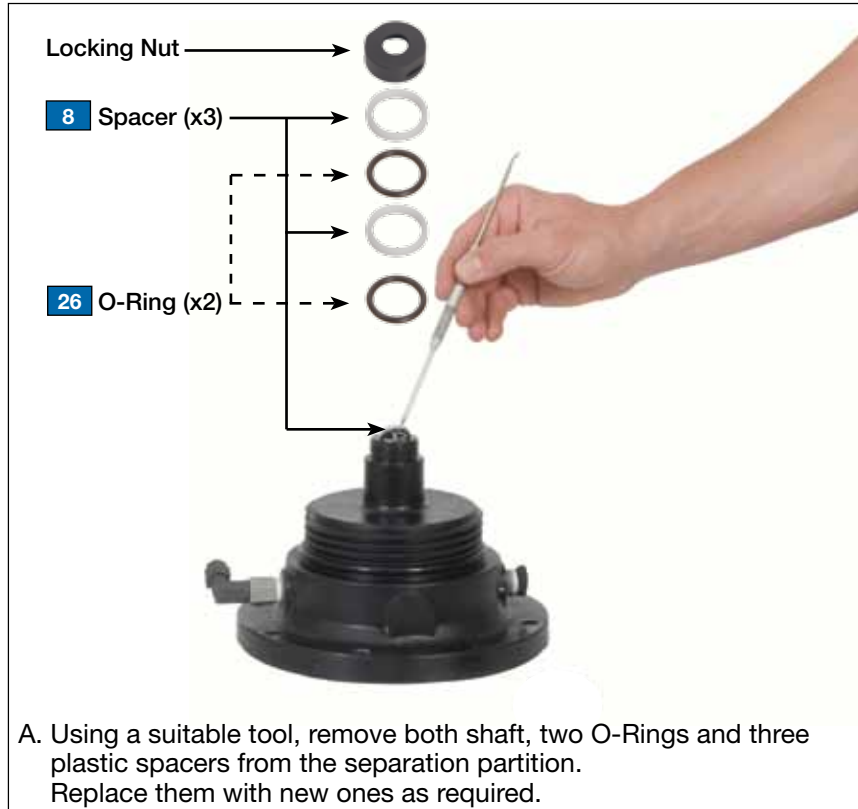

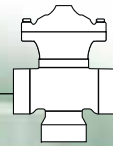

### 5. Replacing the seats

<b>Angle Flow Model</b> Grooved 4"  <b>49</b>	
<b>Straight Flow Model</b> Grooved 4" x Int. Thread 3"  <b>49a</b>	
<b>Straight Flow Model</b> Union Connector (Havazelet) 75mm  <b>49b</b>	

A. Separate the lower adaptor from the valves' body, using a 17mm wrench.



B. Separate the valve body assembly from the lower Adaptor assembly, using a screwdriver.

 <p>Upper Seat</p>	 <p>Lower Seat</p>
---	--

C. Inspect the seats visually. In case of damage, go to next step (C).

\* For authorized technician only!



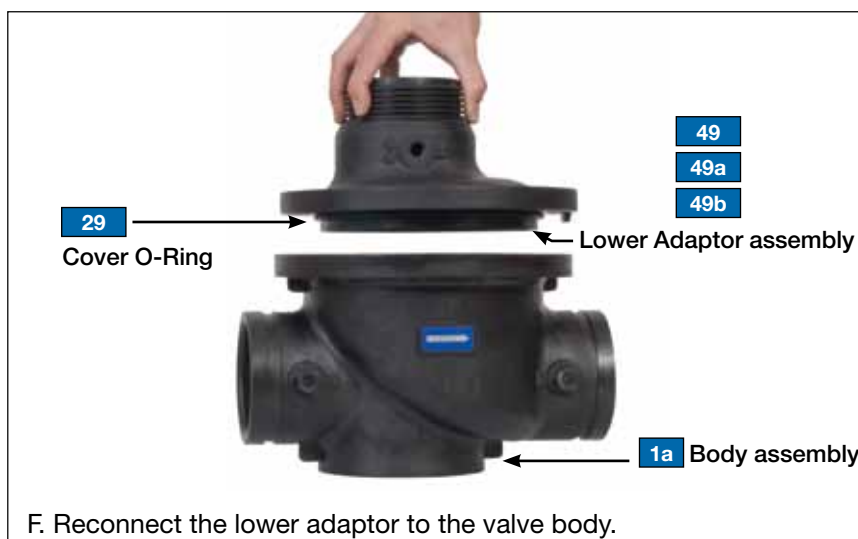
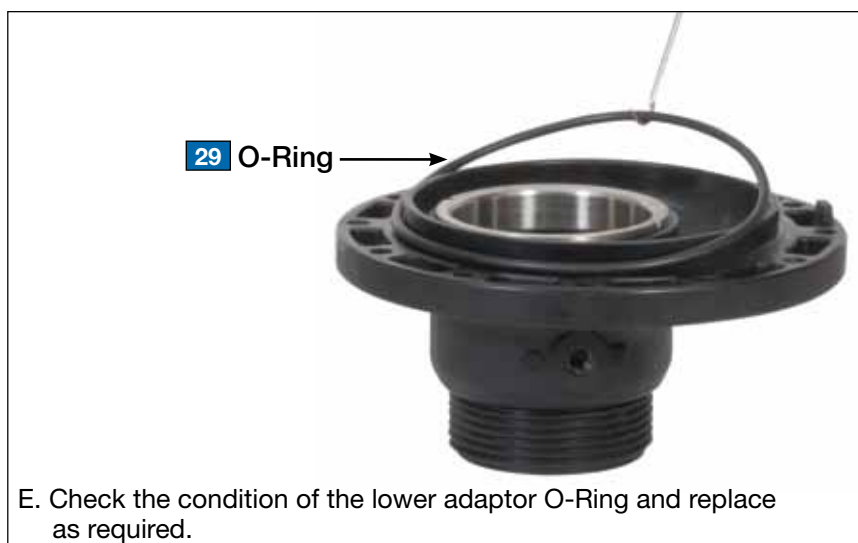
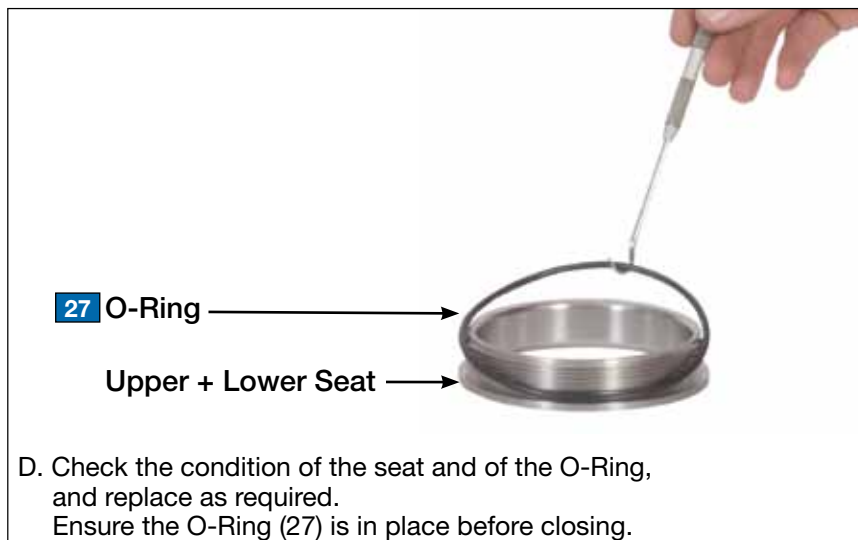
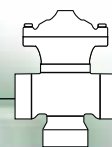

# BERMAD Maintenance Instructions

## Plastic Backwash Filter Valves, Double Chamber, Straight/Angle & Reverse Flow - Model 350 4X4 (Page 10d in BERMAD's Spare Parts Guide)

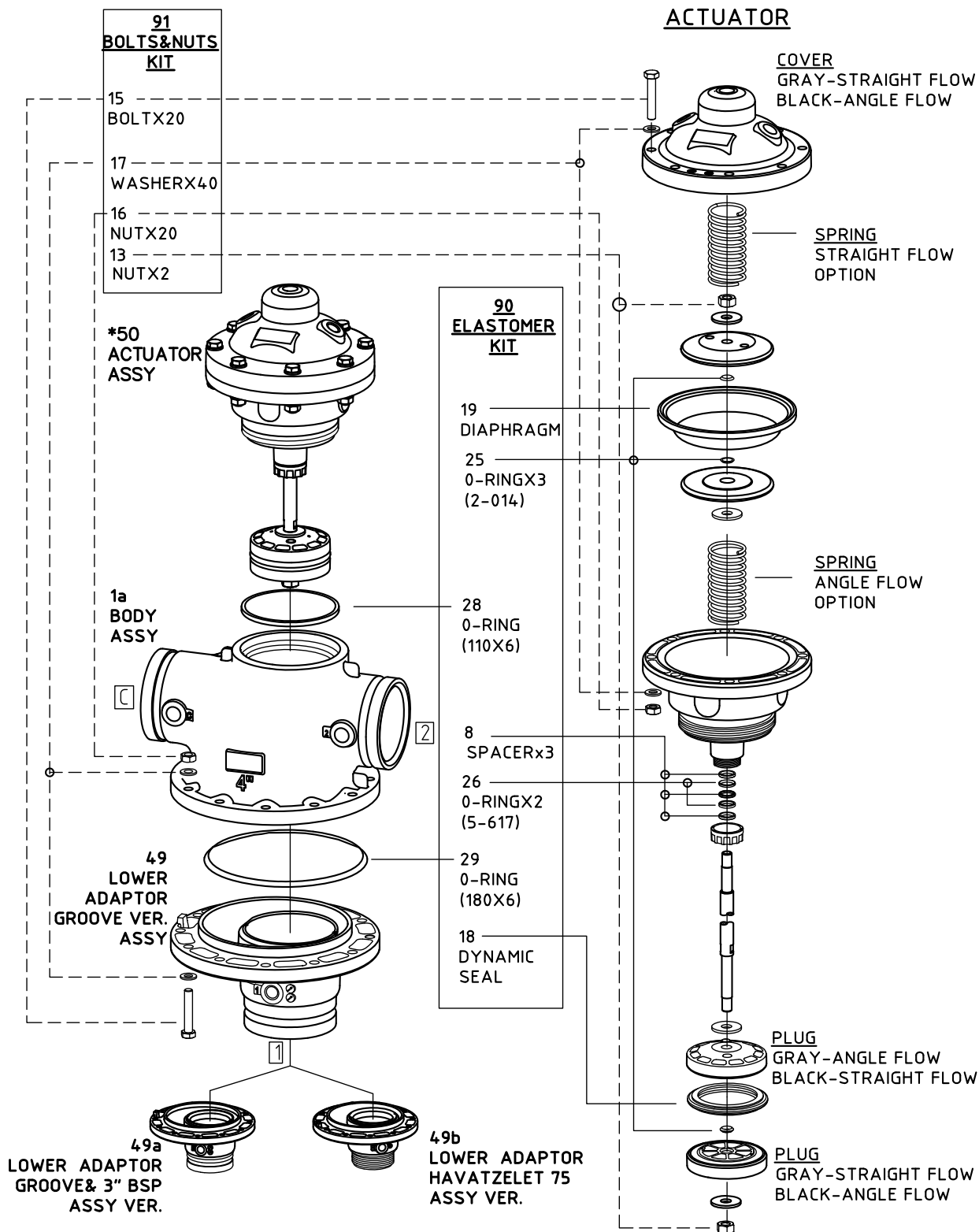

\* ACCORDING TO VALVE TYPE

# BERMAD Maintenance Instructions

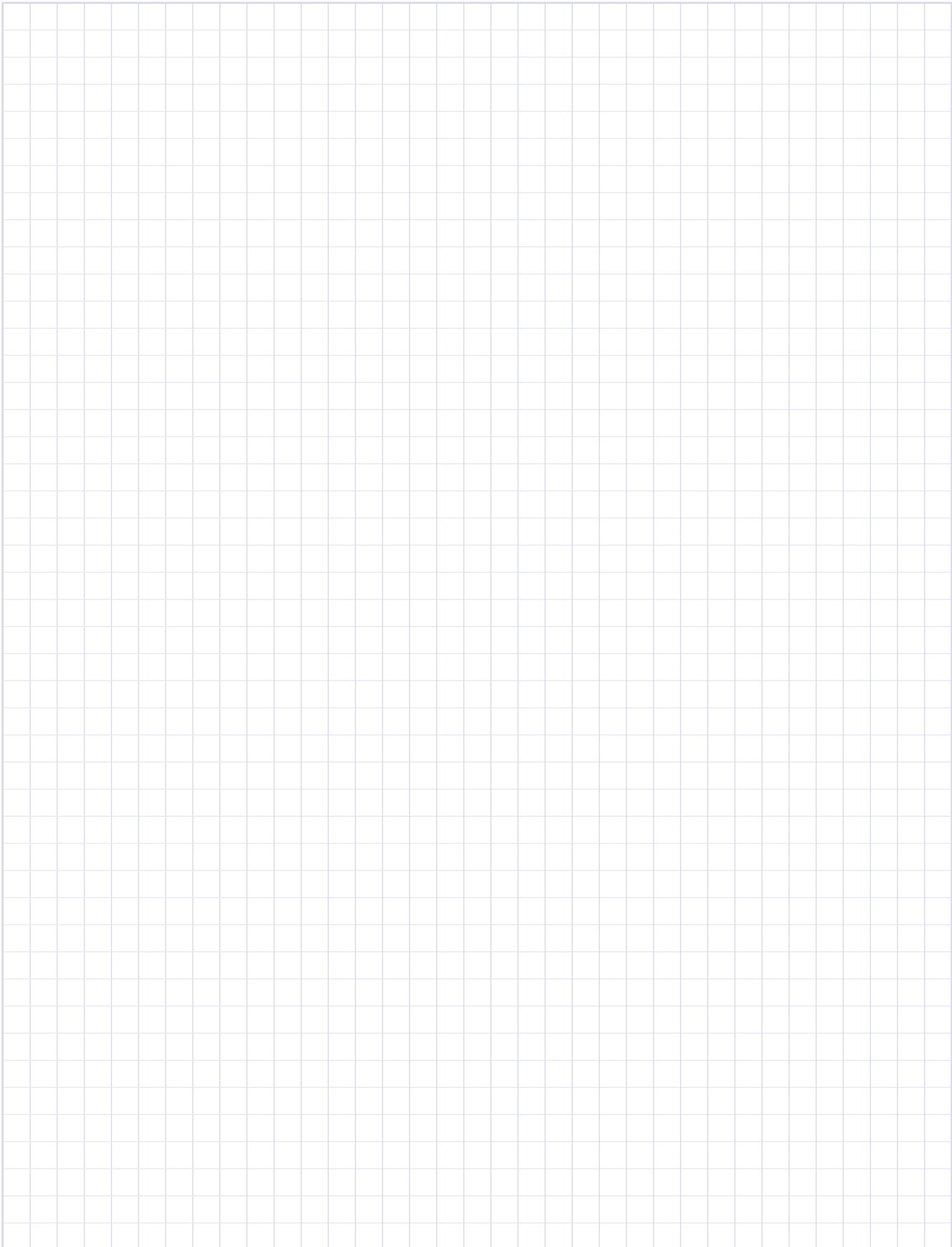

# BERMAD

Water Control Solutions

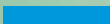
  
BERMAD  
Waterworks

  
BERMAD  
Fire Protection

  
BERMAD  
Petroleum

  
BERMAD  
Irrigation

  
BERMAD  
Landscape

