

# Drawing

Figure 1

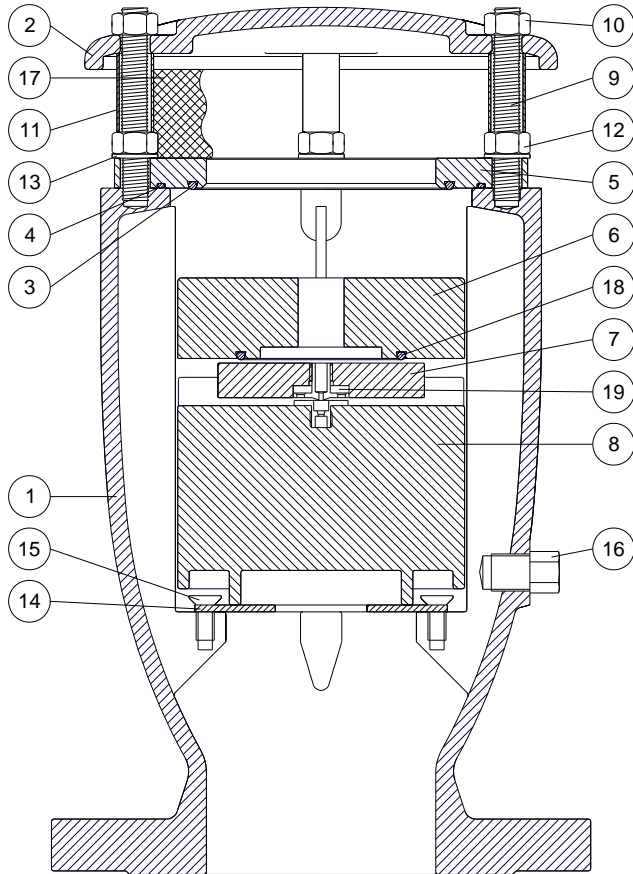

| N.                           | Component     | Material                |
|------------------------------|---------------|-------------------------|
| 1                            | Body          | GJS 500-7/GJS 450-10    |
| 2                            | Cap           | GJS 500-7/GJS 450-10    |
| 3                            | O-ring        | NBR/EPDM/Viton/Silicone |
| 4                            | O-ring        | NBR/EPDM/Viton/Silicone |
| 5                            | Seat          | AISI 304/AISI 316       |
| 6                            | RFP flat      | Polypropylene           |
| 7                            | Upper flat    | Polypropylene           |
| 8                            | Float         | Polypropylene           |
| 9                            | Studs         | AISI 304/AISI 316       |
| 10                           | Nuts          | AISI 304/AISI 316       |
| 11                           | Spacers       | AISI 304/AISI 316       |
| 12                           | Nuts          | AISI 304/AISI 316       |
| 13                           | Washers       | AISI 304/AISI 316       |
| 14                           | Deflector     | AISI 304/AISI 316       |
| 15                           | Screws        | AISI 304/AISI 316       |
| 16                           | Drain valve   | AISI 303/AISI 316       |
| 17                           | Screen        | AISI 304                |
| 18                           | O-ring        | NBR/EPDM/Viton/Silicone |
| 19                           | Nozzle subset | AISI 316                |
| Spare parts: 3-4-6-7-8-18-19 |               |                         |